

# RESOLUTION

**#98-09-24** c

WHEREAS, Grant County has been petitioned to accept an extended portion of Copper Drive located within the Trails of Tyrone Subdivision Phase I, Grant County, New Mexico into the Grant County Road System, for maintenance AND

WHEREAS, the roadway has a 60 foot dedicated right of way, the road is defined more specifically AS:

Copper Drive, Trails of Tyrone, Phase I - 0.130 miles aprox.  
B.O.R. At previous turn around E.O.R. End Of Pavement  
Plat recorded: Book 7 of Plats Pages 187-9  
Please See Attached Maps

THEREFORE, BE IT RESOLVED that the Grant County Board of Commissioners did accept the extension of Copper Drive, within the Trails of Tyrone, Phase I, at their regular meeting, on September 24, 1998, into the Grant County Road System.

DONE THIS 24th day of September, 1998, by the Board of Grant County Commissioners.

## BOARD OF GRANT COUNTY COMMISSIONERS



Manuel T. Serna, Chairman

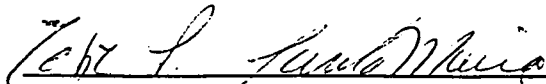

Zeke P. Santa Maria, Member

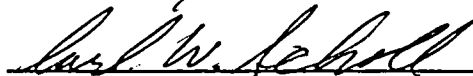

Carl W. Scholl, Member

Attest:

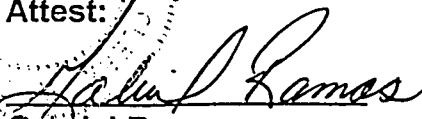

Gabriel Ramos  
Grant County Clerk

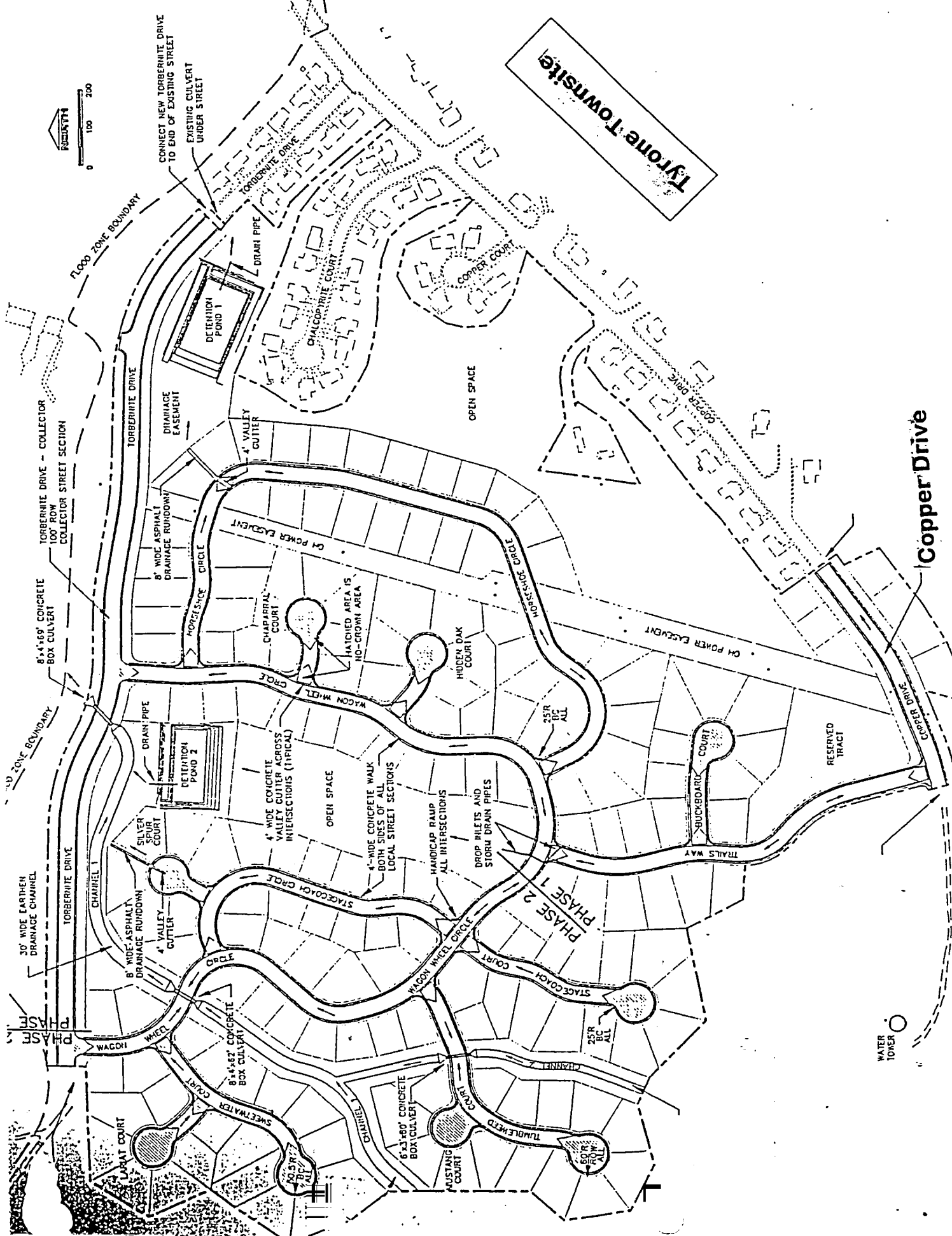

Tyrone Township

Copper Drive

WATER TOWER



FLOOD ZONE BOUNDARY

TORBERNITE DRIVE - COLLECTOR  
100' ROW  
COLLECTOR STREET SECTION

8'-4" x 6" CONCRETE  
BOX CULVERT

FLOOD ZONE BOUNDARY

30' WIDE EARTHEN  
DRAINAGE CHANNEL

PHASE 1

CONNECT NEW TORBERNITE DRIVE  
TO END OF EXISTING STREET  
EXISTING CULVERT  
UNDER STREET

DETENTION  
POND 1

DRAINAGE  
EASEMENT

4" VALLEY  
CUTTER

8' WIDE ASPHALT  
DRAINAGE RUNDOWN

4" POWER EASEMENT

4" VALLEY  
CUTTER

8' WIDE ASPHALT  
DRAINAGE RUNDOWN

4" VALLEY  
CUTTER

8' WIDE ASPHALT  
DRAINAGE RUNDOWN

4" VALLEY  
CUTTER

8' WIDE ASPHALT  
DRAINAGE RUNDOWN

4" VALLEY  
CUTTER

8' WIDE ASPHALT  
DRAINAGE RUNDOWN

4" VALLEY  
CUTTER

8' WIDE ASPHALT  
DRAINAGE RUNDOWN

CHAPARRAL COURT

HATCHED AREA IS  
NO-CROWN AREA

HIDDEN OAK COURT

4" WIDE CONCRETE  
VALLEY CUTTER ACROSS  
INTERSECTIONS (TYPICAL)

OPEN SPACE

4" WIDE CONCRETE WALK  
BOTH SIDES OF ALL  
LOCAL STREET SECTIONS

HANDICAP RAMP  
ALL INTERSECTIONS

DROP INLETS AND  
STORM DRAIN PIPES

STAGE COACH COURT

STAGE COACH COURT

STAGE COACH COURT

WAGON WHEEL COURT

25' R  
10' R  
ALL

TRAILS WAY

BUCKBOARD COURT

RESERVED TRACT

PHASE 2

STAGE COACH COURT

STAGE COACH COURT

STAGE COACH COURT

STAGE COACH COURT

STAGE COACH COURT

25' R  
10' R  
ALL

TRAILS WAY

BUCKBOARD COURT

RESERVED TRACT

PHASE 2

STAGE COACH COURT

STAGE COACH COURT

STAGE COACH COURT

STAGE COACH COURT

STAGE COACH COURT

STAGE COACH COURT

25' R  
10' R  
ALL

TRAILS WAY

BUCKBOARD COURT

RESERVED TRACT

PHASE 2

STAGE COACH COURT

STAGE COACH COURT

STAGE COACH COURT

STAGE COACH COURT

STAGE COACH COURT

STAGE COACH COURT

25' R  
10' R  
ALL

TRAILS WAY

BUCKBOARD COURT

RESERVED TRACT

PHASE 2

STAGE COACH COURT

STAGE COACH COURT

STAGE COACH COURT

STAGE COACH COURT

STAGE COACH COURT

STAGE COACH COURT

25' R  
10' R  
ALL

TRAILS WAY

BUCKBOARD COURT

RESERVED TRACT

PHASE 2

STAGE COACH COURT

STAGE COACH COURT

STAGE COACH COURT

STAGE COACH COURT

STAGE COACH COURT

STAGE COACH COURT

25' R  
10' R  
ALL

TRAILS WAY

BUCKBOARD COURT

RESERVED TRACT

PHASE 2

STAGE COACH COURT

STAGE COACH COURT

STAGE COACH COURT

STAGE COACH COURT

STAGE COACH COURT

STAGE COACH COURT

25' R  
10' R  
ALL

TRAILS WAY

BUCKBOARD COURT

RESERVED TRACT

PHASE 2

STAGE COACH COURT

STAGE COACH COURT

STAGE COACH COURT

STAGE COACH COURT

STAGE COACH COURT

STAGE COACH COURT

25' R  
10' R  
ALL

TRAILS WAY

BUCKBOARD COURT

RESERVED TRACT

PHASE 2

STAGE COACH COURT

STAGE COACH COURT

STAGE COACH COURT

STAGE COACH COURT

STAGE COACH COURT

STAGE COACH COURT

25' R  
10' R  
ALL

TRAILS WAY

BUCKBOARD COURT

RESERVED TRACT

PHASE 2

STAGE COACH COURT

STAGE COACH COURT

STAGE COACH COURT

STAGE COACH COURT

STAGE COACH COURT

STAGE COACH COURT

25' R  
10' R  
ALL

TRAILS WAY

BUCKBOARD COURT

RESERVED TRACT

PHASE 2

STAGE COACH COURT

STAGE COACH COURT

STAGE COACH COURT

STAGE COACH COURT

STAGE COACH COURT

STAGE COACH COURT

25' R  
10' R  
ALL

TRAILS WAY

BUCKBOARD COURT

RESERVED TRACT

PHASE 2

STAGE COACH COURT

STAGE COACH COURT

STAGE COACH COURT

STAGE COACH COURT

STAGE COACH COURT

STAGE COACH COURT

25' R  
10' R  
ALL

TRAILS WAY

BUCKBOARD COURT

RESERVED TRACT

PHASE 2

STAGE COACH COURT

STAGE COACH COURT

STAGE COACH COURT

STAGE COACH COURT

STAGE COACH COURT

STAGE COACH COURT

25' R  
10' R  
ALL

TRAILS WAY

BUCKBOARD COURT

RESERVED TRACT

PHASE 2

STAGE COACH COURT

STAGE COACH COURT

STAGE COACH COURT

STAGE COACH COURT

STAGE COACH COURT

STAGE COACH COURT

25' R  
10' R  
ALL

TRAILS WAY

BUCKBOARD COURT

RESERVED TRACT

PHASE 2

STAGE COACH COURT

STAGE COACH COURT

STAGE COACH COURT

STAGE COACH COURT

STAGE COACH COURT

STAGE COACH COURT

25' R  
10' R  
ALL

TRAILS WAY

BUCKBOARD COURT

RESERVED TRACT

PHASE 2

STAGE COACH COURT

STAGE COACH COURT

STAGE COACH COURT

STAGE COACH COURT

STAGE COACH COURT

STAGE COACH COURT

25' R  
10' R  
ALL

TRAILS WAY

BUCKBOARD COURT

RESERVED TRACT

PHASE 2

STAGE COACH COURT

STAGE COACH COURT

STAGE COACH COURT

STAGE COACH COURT

STAGE COACH COURT

STAGE COACH COURT

25' R  
10' R  
ALL

TRAILS WAY

BUCKBOARD COURT

RESERVED TRACT

PHASE 2

STAGE COACH COURT

STAGE COACH COURT

STAGE COACH COURT

STAGE COACH COURT

STAGE COACH COURT

STAGE COACH COURT

25' R  
10' R  
ALL

TRAILS WAY

BUCKBOARD COURT

RESERVED TRACT

PHASE 2

STAGE COACH COURT

STAGE COACH COURT

STAGE COACH COURT

STAGE COACH COURT

STAGE COACH COURT

STAGE COACH COURT

25' R  
10' R  
ALL

TRAILS WAY

BUCKBOARD COURT

RESERVED TRACT

PHASE 2

STAGE COACH COURT

STAGE COACH COURT

STAGE COACH COURT

STAGE COACH COURT

STAGE COACH COURT

STAGE COACH COURT

25' R  
10' R  
ALL

TRAILS WAY

BUCKBOARD COURT

RESERVED TRACT

PHASE 2

STAGE COACH COURT

STAGE COACH COURT

STAGE COACH COURT

STAGE COACH COURT

STAGE COACH COURT

STAGE COACH COURT

25' R  
10' R  
ALL

TRAILS WAY

BUCKBOARD COURT

RESERVED TRACT

PHASE 2

STAGE COACH COURT

STAGE COACH COURT

STAGE COACH COURT

STAGE COACH COURT

STAGE COACH COURT

STAGE COACH COURT

25' R  
10' R  
ALL

TRAILS WAY

BUCKBOARD COURT

RESERVED TRACT

PHASE 2

STAGE COACH COURT

STAGE COACH COURT

STAGE COACH COURT

STAGE COACH COURT

STAGE COACH COURT

STAGE COACH COURT

25' R  
10' R  
ALL

TRAILS WAY

BUCKBOARD COURT

RESERVED TRACT

PHASE 2

STAGE COACH COURT

STAGE COACH COURT

STAGE COACH COURT

STAGE COACH COURT

STAGE COACH COURT

STAGE COACH COURT

25' R  
10' R  
ALL

TRAILS WAY

BUCKBOARD COURT

RESERVED TRACT

PHASE 2

STAGE COACH COURT

STAGE COACH COURT

STAGE COACH COURT

STAGE COACH COURT

STAGE COACH COURT

STAGE COACH COURT

25' R  
10' R  
ALL

TRAILS WAY

BUCKBOARD COURT

RESERVED TRACT

PHASE 2

STAGE COACH COURT

STAGE COACH COURT

STAGE COACH COURT

STAGE COACH COURT

STAGE COACH COURT

STAGE COACH COURT

25

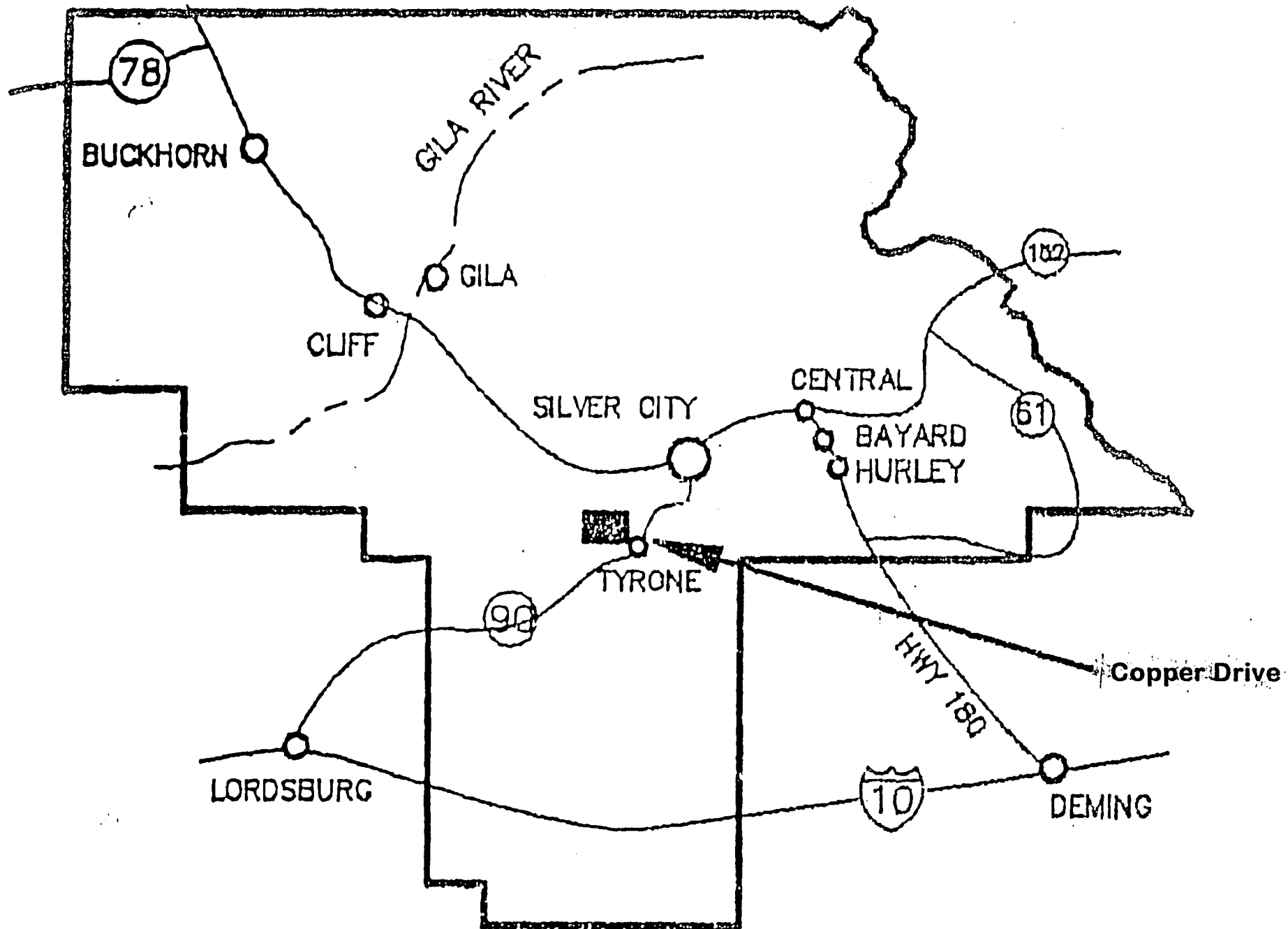

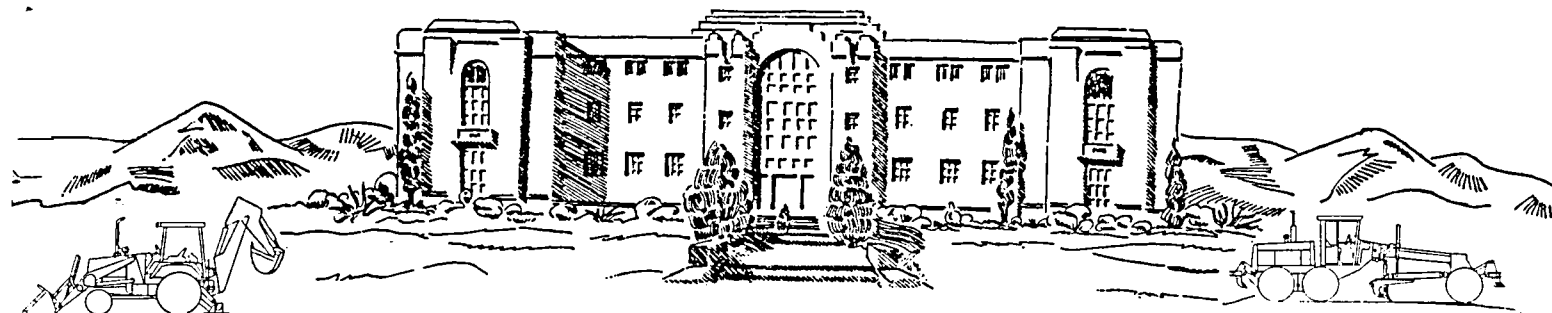

## GRANT COUNTY ROAD DEPARTMENT

Tim Zamora, Road Superintendent

# **MEMO**

**To: Alma Para, Commission' Secretary**

**From: Tim <sup>TZ</sup>Zamora, Road Superintendent**

**Date: September 18, 1998**

**Re: Copper Drive, Trails of Tyrone Phase I**

---

I would like to request to be put on the Grant County Board of Commissioners agenda for their regular scheduled meeting on September 24, 1998, regarding acceptance of 0.130 approximate additional mileage to be maintained by Grant County on Copper Drive within the Trails of Tyrone Phase I.

A resolution accepting the additional mileage is also attached for approval by the County Commission.

**Never Take Risks With Safety.**

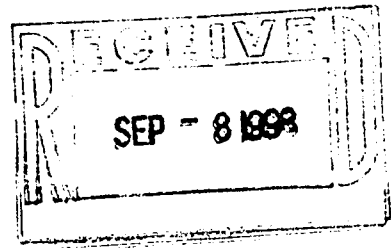

September 2, 1998

Tim Zamora  
Road Superintendent  
Grant County  
P.O. Box 898  
Silver City, NM 88062

RE: THE TRAILS AT TYRONE PHASE 1

Dear Mr. Zamora:

Champion Homes has completed the bonded improvements for The Trails at Tyrone Phase 1. We respectfully petition Grant County to accept the roads at this time.

Our understanding is that this item may be placed on the September 24, 1998 Board of County Commissioners meeting agenda. Please contact us to schedule a final inspection at your earliest convenience.

Sincerely,

CHAMPION HOMES NEW MEXICO, INC.

A handwritten signature in black ink, appearing to read "Van G. Martin".

Van G. Martin  
Vice President of Construction

cc: Dolores Dominguez  
Art Buck  
Ken Netz  
Bob Blair

