

RESOLUTION No. R-18-04

2018 GRANT COUNTY MAINTAINED ROADS

WHEREAS, the Board of County Commissioners met in regular session on February 15th, 2018 where the following was resolved; and

WHEREAS, the Board of County Commissioners hereby certifies that Fleming Tank Road (0.88) miles, Wind Canyon Road (1.6) miles, Ridge Rd (13.86) miles and Stephens Road (3.18) miles are adjusted to the correct mileage of Fleming Tank Road (1.4) miles, Wind Canyon Road (2.2) miles, Ridge Road (11.95) miles and Stephens Road (0.40) miles and,

WHEREAS, the addition of Airport Road (1.9) miles and,

WHEREAS, The Board of County Commissioners hereby certifies a total of **697.93** miles for the year 2018, herein attached.

DONE IN SILVER CITY, GRANT COUNTY, NEW MEXICO THIS 15th DAY OF FEBRUARY 2018

BOARD OF GRANT COUNTY COMMISSIONERS



GERALD W. BILLINGS JR., CHAIRMAN

ALICIA EDWARDS, VICE CHAIR



GABRIEL RAMOS, MEMBER



BRETT KASTEN, MEMBER



HARRY BROWNE, MEMBER

Attest:



MARISA CASERILLO, GRANT COUNTY CLERK

by: 

DEPUTY CLERK



New Mexico Department of Transportation
State Maintenance Bureau, SB-2
Attention: Robert Young
P.O. Box 1149
Santa Fe, NM 87504-1149

Re: 2018 Grant County Road Mileage Inventory

Dear Mr. Medina:

The following corrections have been made to the Grant County Road inventory:
Fleming Tank Road (0.88) miles, Wind Canyon Road (1.60) miles, Ridge Road (13.86) and
Stephens Road (3.18) miles are adjusted to the correct mileage of Fleming Tank Rd (1.40) miles,
Wind Canyon Rd (2.20) miles, Ridge Rd (11.95) miles and Stephens Rd (0.40) miles.

The following addition and name change have been made:
Airport Road (1.9) miles is added mileage.

The following deletions have been made:
Stephens Road (2.78) miles, partial vacation of road.

We the undersigned Grant County Board of County Commissioners do hereby certify that
approximately 697.93 miles of roadway is maintained by Grant County as of January 1, 2018.

Signed this 15th day of February 2018

BOARD OF GRANT COUNTY COMMISSIONERS

Gerald W. Billings Jr., Chairman

Alicia Edwards, Vice Chair

Gabriel Ramos, Member

Brett Kasten, Member

Harry Browne, Member

[SEAL]

ATTEST

Marisa Castillo, County Clerk



CH

2018 GRANT COUNTY MAINTAINED ROADS

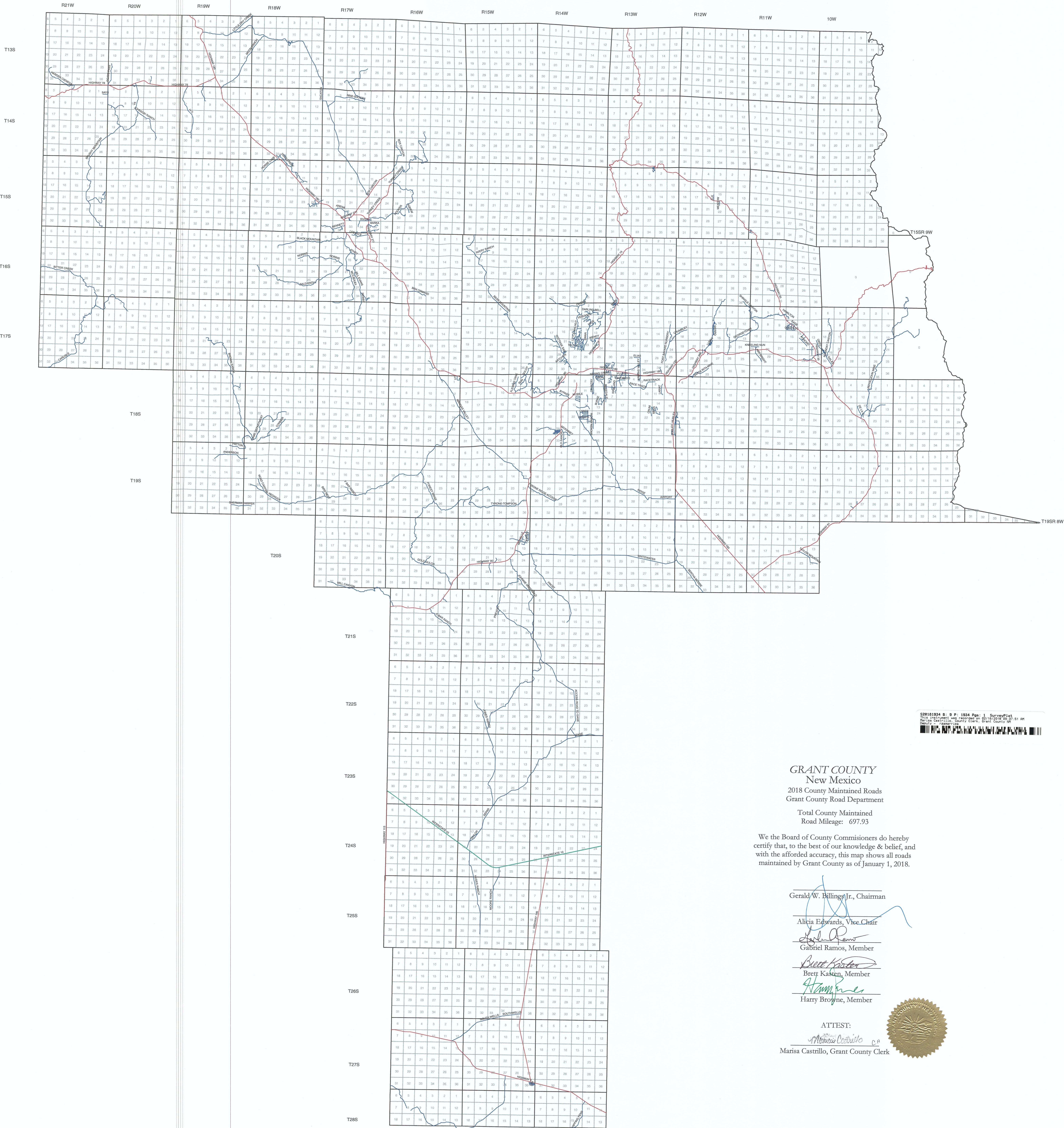

COUNTY MAINTAINED ROUTE DESCRIPTION
For Annual Certified County Maintained Mileage Report

COUNTY: GRANT

YEAR 2018

ROUTE NAME	ROUTE NUMBER	FROM: BEGINNING TERMINI	TO: ENDING TERMINI	MILEAGE Length of Maintained Section	TOTAL Roadway Width (In Feet)	TYPE OF ROADWAY Surface (Refer to codes at bottom left)	COMMENTS:
D-1							
Fairway Drive	1-1	From its intersection with Ridge Road East	Entrance to Rd Dept Offices	1.40	24	1	
Ridge Road	1-2	From end of city limits (300' past Lance)	Intersection of Airport Rd	11.95	24	1&3	Mileage Changed
Lance Drive	1-3	From its intersection with Ridge Road East	Intersection with Tabor Drive	1.10	22	1	
Bonita Avenue	1-4	From its intersection with Lance South	Intersection with Ridge Rd	0.63	20	1	
Vicente Place	1-5	From its intersection with Lance north & South	Intersection with Spear Dr S	0.17	20	1&3	
Tabor Avenue	1-6	From its intersection with Country Club South	Intersection with Trailing Heart	0.81	18	1&3	
Tabor Ave continues	1-6	From its intersection with Apache St. South	To turn around		18		
Country Club	1-7	From its intersection with Vicente Place East	Intersection with Tabor Drive	0.46	19	1	
Spear Drive	1-8	From its intersection with Vicente Place East	Intersection with Tabor Drive	0.47	20	1	
Broken Arrow	1-9	From its intersection with Bonita Ave East	Intersection with Filaree	2.18	20	1&3	
Trailing Heart	1-10	From its intersection with Bonita Ave East	Intersection with Tabor Drive	0.74	21	3	
Apache Street	1-11	From its intersection with Bonita Ave East	Intersection with Tabor Drive	0.65	19	1	
Broken Bow	1-12	From its intersection with Apache	To turn around	0.34	21	3	
Tomahawk Road	1-13	From its intersection with Tabor Ave East	First Cattleguard	0.08	12	3	
Pheasant Drive	1-14	From its intersection with Ridge Road East	Resident # 735 Turn-around	0.45	22	1	
North Pheasant Drive	1-15	From its intersection with Pheasant, North	Resident # 680	0.08	18	1	
Sky View Drive	1-16	From its intersection with Ridge Road East	Intersection with Grand Mesa	0.40	24	1	
Grand Mesa	1-17	From its intersection with Sky View Dr, N&S	Resident # 3755 Turn-around	0.10	24	1	
Mountain View Road	1-18	From its intersection with Ridge Road East	Cul De Sac @ .44 mi	0.44	18	1	
Mobile Drive	1-19	From its intersection with Ridge Road East	Cul De Sac @ .50 mi	0.50	18	1	
By Pass Road	1-20	From its intersection with Hwy 90 South	Intersection with Hwy 180 W	1.90	22	1	
Lomita Drive	1-21	From its intersection with By Pass Rd South	Resident # 17 entrance	0.14	14	3	
Western Drive	1-22	From its intersection with By Pass Rd North	Intersection with Hwy 180 W	0.70	22	1	
McKinney Road	1-23	From its intersection with Hwy 90 S, East	Resident # 1106 entrance	1.00	16	3	
Copper Drive	1-24	From its intersection with Hwy 90 South	End of Pavement	0.86	36	1	
Turquoise Drive	1-25	From its intersection with Copper Drive, North	End of .11 miles	0.11	36	1	
Malachite Avenue	1-26	From its intersection with Copper Drive, South	Tenorite Court	0.60	26	1	
Chrysocolla Avenue	1-27	From its intersection with Copper Drive, South	Cuprite Street	0.14	26	1	
Torbernite Drive	1-28	From its intersection with Copper Drive, West	Intersection with Bald Mt Rd	0.09	26	1	

CODES FOR SURFACE TYPE:

- 1=Paved Roadway
- 2=Graveled Roadway
- 3=Dirt Roadway
- 4=Other Surface Types

D-1							
Chalcopyrite Ave & Court	1-29	From its intersection with Copper Dr, NW & S	Tenorite Crt (crosses 4 Sts)	0.36	26	1	
Copper Court	1-30	From its intersection with Copper Dr, NW& SE	Turn Around	0.05	26	1	
Azurite Court	1-31	From its intersection with Malachite Ave, east	Turn Around	0.06	26	1	
Bornite Street & Court	1-32	From its intersection with Malachite Ave, E&W	Chalcopyrite(west)EOR(east)	0.40	26	1	
Chalcocite Court & Street	1-33	From its intersection with Malachite Ave, E&W	Cul de Sac @ .50 mi	0.50	26	1	
Cuprite Court & Street	1-34	From its intersection with Malachite Ave, E&W	Copper Drive	0.52	26	1	
Tenorite Court	1-35	From its intersection with Malachite Ave,north	Turn Around	0.06	26	1	
Melanconite Avenue	1-36	From its intersection with Cuprite St.,south	Covellite Drive	0.05	26	1	
Covellite Drive	1-37	From its intersection with Melanconite, E&W	Turn Around	0.16	26	1	
Bald Mountain Road	1-38	From its intersection with EOP of Torbernite Dr	Resident # 90 gate entrance	2.10	18	3	
Oakwood Avenue East	1-39	From its intersection with Hwy 180 W, west	Cul De Sac @ .48 mi	0.48	30	1	
Cottage San Road	1-40	From its intersection with cty limits @ Alabama	Resident # 2361 (EOR)	3.28	24	1&3	
Opal Drive	1-41	From its intersection with Cottage San Rd, west	Resident # 1106 (EOR)	0.11	20	1	
Emerald Drive	1-42	From its intersection with Cottage San Rd, west	Old water crossing dip	0.30	10	3	
Bandoni Drive	1-43	From its intersection with Cottage San Rd, west	Cottage San Rd (loops back)	1.57	18	3	
Jade Drive	1-44	From its intersection with Cottage San Rd, east	Residents #13 & #15, south	0.10	10	3	
Artcher Road	1-45	From its intersection with Cottage San Rd,south	Resident # 63 entrance	0.63	18	3	
Shale Drive	1-46	From its intersection with Artcher Rd, west	Resident # 12 entrance	0.10	10	3	
Coleman Drive	1-47	From its intersection with Cottage San Rd,north	Coleman Drive (loops back)	0.50	16	1&3	
Sanitarium Road	1-48	From its intersection with Coleman Drive, east	Resident # 59	0.15	16	3	
Iron Drive	1-49	From its intersection with Coleman Drive,north	Resident # 10 entrance	0.08	16	3	
Bear Mt. Ranch	1-50	From its intersection with Cottage San Rd,west	Culvert before Guest Ranch	0.70	12	3	
Bear Mountain Road	1-51	From its intersection with Cottage San Rd,west	Resident #1550 gate @ crk	15.30	18	3	
Avery Ranch Road	1-52	From its intersection with Bear Mt Road, north	Resident #1218 (EOR)	1.83	12	3	
Little Walnut Road	1-53	From its intersection with City Limits	Feeley Subdivision Gate	7.03	24	1&3	
Valley Drive	1-54	From its intersection with Little Walnut Rd, west	First Cattleguard	0.83	16	3	
Old Little Walnut Road	1-55	From its intersection with Little Walnut Rd, west	Resident # 42 entrance	0.40	18	3	
Blackhawk Place	1-56	From its intersection with Cain Drive, north	Cul de Sac @ .14 mi	0.14	19	1	
Grandview Road	1-57	From its intersection with Cain Drive, north	Cottonwood	1.50	27	1	
Zia Circle	1-58	From its intersection with Grandview, west	Cul de Sac @ .09 mi	0.09	22	1	
Arrowhead Road	1-59	From its intersection with Cain Drive, north	Cottonwood	0.72	25	1	
Apache Circle	1-60	From its intersection with Arrowhead Rd, north	Cul de Sac @ .05 mi	0.05	21	1	
Kachina Circle	1-61	From its intersection with Arrowhead Rd, west	Cul de Sac @ .10 mi	0.10	21	1	
Cochise Circle	1-62	From its intersection with Arrowhead Rd, east	Cul de Sac @ .13 mi	0.13	26	1	
Gideon Truesdale	1-63	From its intersection with Grandview, east	Cul de Sac @ .19 mi	0.19	14	1	
Eddie Ward Way	1-64	From its intersection with Grandview, west	Cul de Sac @ .26 mi	0.26	24	1	
Bonney Trail	1-65	From its intersection with EddieWard Way,north	Cul de Sac @ .08 mi	0.08	24	1	
Timmer Way East	1-66	From its intersection with Grandview, west	Cul de Sac @ .10 mi	0.10	24	1	
Timmer Way West	1-67	From its intersection with Grandview, west	Cul de Sac @ .06 mi	0.06	24	1	
Shadow Mountain	1-68	From its intersection with Grandview, west	Cul de Sac @ .32 mi	0.32	18	1	
Cottonwood Road	1-69	From its intersection with Cain Drive, north	Resident # 5200	1.67	24	1	
Rosewood Circle	1-70	From its intersection with Copper Ridge, south	Cul De Sac @ .18 mi	0.18	30	1	
Whispering Hills Road	1-71	From its intersection with Little Walnut Rd, east	Cottonwood	0.59	24	1	
Mountain View Lane	1-72	From its intersection with Whispering Hills,north	Cul De Sac @ .04 mi	0.04	21	1	2
Road Runner Lane	1-73	From its intersection with Whispering Hills,north	Cul De Sac @ .04 mi	0.04	24	1	

D-1							
Iron Wood Lane	1-74	From its intersection with Whispering Hills, west	Cul De Sac @ .09 mi	0.09	23	1	
Holly Lane	1-75	From its intersection with Whispering Hills, west	Cul De Sac @ .11 mi	0.11	23	1	
Piñon Road	1-76	From its intersection with Whispering Hills, west	Cul De Sac @ .11 mi	0.11	23	1	
Deer Trail	1-78	From its intersection with Cottonwood Rd, east	EOR at Cul de Sac	0.51	24	1	
Hide Away Lane	1-79	From its intersection with Cottonwood Rd, east	Cul De Sac	0.11	24	1	
Big Bend Road	1-80	From its intersection with Cottonwood Rd, west	EOR (gate @ resident)	0.45	20	1	
High Lonesome	1-81	From its intersection with Little Walnut, west	Resident # 5103	0.25	14	3	
Village Road	1-82	From its intersection with Little Walnut, east	Cattleguard	0.25	14	3	
Turrietts Road	1-83	From its intersection with Little Walnut, east	Resident # 5210	0.10	10	3	
Cleveland Mine Road	1-84	From its intersection with Little Walnut, north	First Cattleguard	0.30	14	3	
Owens Road	1-85	From its intersection with Little Walnut, north	Joseph Blane Road	0.64	14	3	
North Swan Street	1-86	From its intersection with City Limits	EOP @ 3.82 mi	3.82	26	1	
Owl Hoot Trail	1-87	From its intersection with NM15, west	Turn Around (EOR)	0.75	22	3	
Spur Drive	1-88	From its intersection with Owl Hoot Trail, north	Turn Around past Rsdnt # 13	0.25	20	3	
Wendy Road	1-89	From its intersection with NM15, west	Resident # 110 entrance	1.30	22	3	
Six Shooter Drive	1-90	From its intersection with Wendy Rd, south	Resident # 23 turn around	0.25	22	3	
Radio Tower Road	1-91	From its intersection with NM15, west	Radio Towers	3.30	15	3	
Ranger Street	1-92	From its intersection with NM15, west	Resident # 28 gate	0.28	18	3	
Bear Creek	1-93	From its intersection with NM15, north (at "y")	Cattleguard @ old mine	2.03	20	1&3	
Placer Street	1-94	From its intersection with Bear Creek, east	NM 15	0.18	18	3	
Spring Street	1-95	From its intersection with Bear Creek, south	Main Street(across Bear Ck)	0.36	18	3	
Main Street	1-96	From its intersection with Bear Creek, south	NM 15 (across Bear Creek)	0.94	20	1&3	
Golden Street	1-97	From its intersection with Bear Creek, south	Resident # 18 & Jct frm Chr	0.22	18	3	
Norton Street	1-98	From its intersection with Spring Street, north	Resident # 85 gate	0.40	18	3	
Rock Street	1-99	From its intersection with NM15, south	Resident # 12 entrance	0.11	15	3	
Mountain View Road	1-100	Approx 4mi from Hwy180,(840' past City Limits)	Cul de Sac Resident # 4040	0.50	21	3	
Rosedale Road	1-101	From its intersection with city Limits	Resident # 382 (1st Cattlgrd)	3.40	24	1	
Ethel Lane	1-102	From its intersection with Rosedale Rd, east	Resident # 26	0.26	20	3	
Spring Creek	1-103	From its intersection with Rosedale Rd, east	Resident # 80	0.80	15	3	
Rodeo Road	1-104	From its intersection with Rosedale Rd, east	Resident # 45	0.45	12	3	
Piñon Lane	1-105	From its intersection with Rosedale Rd, east	Resident # 79	0.79	11	3	
Mahogany Drive	1-106	From its intersection with Rosedale Rd, east	Resident # 57	0.55	12	3	
Burke Loop	1-107	From its intersection with Rosedale Rd, west	Grenfell Drive	1.09	17	3	
Grenfell Drive	1-108	From its intersection with Burke	Rosedale Road	0.28	27	3	
Piñon Street	1-109	From its intersection with Casa Loma Rd, west	Johnson Road	0.59	18	1	
Ponderosa Street	1-110	From its intersection with Piñon Street, north	Johnson Road	0.30	15	1	
Johnson Road	1-111	From its intersection with Casa Loma Rd, west	Cul de Sac @ 1.02 mi	1.02	15	1	
Delk Drive	1-112	From its intersection with Johnson Rd, south	Hwy 180 east	0.63	30	1	
Sycamore Street	1-113	From its intersection with Delk Road, west	Delk Road (loop)	0.41	23	1	
Alpine Circle	1-114	From its intersection with Delk Road, south	Cul de Sac @ .11 mi	0.11	30	1	
Fir Street	1-115	From its intersection with Johnson Rd, east	Sycamore Street	0.09	28	1	
Shasta Street	1-116	From its intersection with(undeveloped) Bell St	Piñon Lane	0.33	20	3	
Rainer Street	1-117	From its intersection with Hwy 180, south	South of Church	0.16	26	3	
Peterson Drive	1-118	From its intersection with Hwy 180, south	Pike	1.10	30	1	3
Bell Street	1-119	From its intersection with Peterson Drive, west	Resident # 3821	0.23	11	1	

D-1							
Cook Street	1-120	From its intersection with Bell Street, north	First Culvert	0.05	18	1	
Hood Street	1-121	From its intersection with Peterson Drive, west	Resident # 16 fence line	0.15	12	1	
Robson Street	1-122	From its intersection with Peterson Drive, west	Resident # 12	0.13	14	1	
McKinley Street	1-123	From its intersection with Peterson Drive, west	Turn Around	0.18	18	1	
Lassen Street	1-124	From its intersection with Flury Lane, south	Resident # 25 entrance	0.25	28	3	
Casa Loma Road	1-125	From its intersection with Hwy 180, north	Resident # 280999	0.64	24	1&3	
Caballero Drive	1-126	From its intersection with Hwy 180, south	104' toward Rodeo Arena	0.02	28	3	
Kirkland Road	1-127	From its intersection with Hwy 180, south	Resident # 229 cattle guard	2.29	30	1&3	
Mathers Road	1-128	From its intersection with Kirkland Rd, south	Escobedo Lane	0.60	14	3	
Flury Lane	1-129	From its intersection with Racetrack Rd, west	Lassen Street	1.02	22	3	
Sunset Trail	1-130	From its intersection with Kirkland Rd, west	Turn Around	0.25	14	3	
Escobedo Lane	1-131	From its intersection with Kirkland Rd, east	Cul de Sac @ .50 mi	0.50	14	1	
Whiskey Creek Airport Rd	1-132	From its intersection with Kirkland Rd, south	Whiskey Creek Airport	0.64	14	1	
Adams Lane	1-133	From its intersection with Mathers Rd, east	Morales Road	0.25	15	3	
Morales Road	1-134	From its intersection with Hwy 180, south	Adams Lane	0.51	12	1	
Arenas Valley Road	1-135	From its intersection with Hwy 180, north	Hwy 180 east (loop)	2.60	24	1	
Elias Road	1-136	From its intersection with Arenas Valley Rd, N	Resident # 53 gate	0.50	12	3	
Paisano Street	1-137	From its intersection with Arenas Valley Rd, W	Cherry Street	0.14	12	3	
Encina Street	1-138	From its intersection with Paisano Street, north	Resident # 6	0.06	18	3	
Cherry Street	1-139	From its intersection with Paisano Street, north	Arenas Valley Road	0.12	14	3	
Paloma Street	1-140	From its intersection with Arenas Valley Rd, W	Resident # 10 dead end	0.07	13	3	
Racetrack Road	1-141	From its intersection with Hwy 180, south	S Clara Cty limit before PMA	3.74	24	1	
Crum Road	1-142	From its intersection with Racetrack Rd, south	Resident # 251 Ranch	2.51	12	3	
Frank's Road	1-143	From its intersection with Crum Road, east	Mesa Trail	0.55	24	3	
Mesa Trail	1-144	From its intersection with Frank's Rd, N & S	Green Valley Drive	1.19	22	3	
Green Valley Drive	1-145	From its intersection with Mesa Trail, N & S	Cul de Sac Resident # 24	0.25	22	3	
Monte Street	1-146	From its intersection with Hwy 180, north	Resident # 14	0.10	11	3	
Burnham Street	1-147	From its intersection with Yucca Valley, west	VFW parking lot entrance	0.05	16	3	
Yucca Valley Drive	1-148	From its intersection with Hwy 180, south	Cul de Sac	0.51	20	3	
Yucca Pod Lane	1-149	From its intersection with Yucca Valley, west	Yucca Stalk Lane	0.12	17	3	
Yucca Stalk Lane	1-150	From its intersection with Yucca Pod, N & S	Cul de Sac resident 31 & 32	0.20	20	3	
Fort Bayard Road	1-151	From its intersection with Hwy 180, north	Ft. Byd entrance @ cattlegd	0.50	20	1	
Ft. Bayard Nursery Road	1-152	From its intersection with USFS cattleguard	USFS Training Center	3.00	20	3	
Crumbley Road	1-153	From its intersection with Ft. Byd Nrsy Rd, north	Cattleguard resident # 185	1.70	20	3	
Lariat Road	1-154	From its intersection with Bellm Street, south	Resident # 92	0.92	16	3	
North Hurley Road	1-155	From its intersection with Hwy 180, east	North-gate, South-City Limits	2.25	24	1	
Main Street	1-156	From its intersection with N Hurley Rd, south	Pop Morrison	0.14	14	1	
Hill Street	1-157	From its intersection with Main Street, west	Resident # 14	0.14	10	1	
Cottonwood Street	1-158	From its intersection with Main Street, north	Resident # 20	0.20	14	1	
Pop Morrison	1-159	From its intersection with Main Street, north	Cottonwood Street	0.04	14	1	
Horseshoe Drive	1-160	From its intersection with N Hurley Rd, east	North Hurley Road (loops)	1.00	20	1	
Geronimo Street	1-161	From its intersection with Horseshoe Dr, south	North Hurley Road	0.16	14	1	
Delancey Road	1-162	From its intersection with Horseshoe Dr, south	Resident # 38 fence line	0.20	14	3	
Agua Blanca	1-163	From its intersection with Horseshoe Dr, north	Geronimo Street	0.20	12	1	4
Monte Vista	1-164	From its intersection with Horseshoe Dr, north	North Hurley Road	0.10	12	1	

D-1							
North Hurley Overpass Rd	1-165	From its intersection with N Hurley Rd, west	Transfer Station gate	1.10	20	1	
Santa Rita Mine Road	1-166	From its intersection with NM356 @ RR tracks	Guard Shack Gate line	0.80	24	1	
Ground Hog Mine Road	1-167	From its intersection with Santa Rita Mine Rd,S	School Bus Turn Around	0.30	14	1	
Tanglewood Circle	1-168	From its intersection with Little Walnut Rd, east	Past Resident # 14	0.152	32	1	
Copper Ridge Drive	1-169	From its intersection with Tanglewood, north	Cottonwood Road	0.385	30	1	
Briarwood Lane	1-170	From its intersection with Copper Ridge, east	Palo Verde	0.61	36	1	
Helen Lynch Place	1-171	From its intersection with Cottonwood Rd, north	Cul de Sac @ .08 mi	0.08	24	1	
Schiff Trail	1-172	From its intersection with Cottonwood Rd, east	Grandview Road	0.26	24	1	
Sully Circle	1-173	From its intersection with Grandview Rd, east	Cul de Sac @ .06 mi	0.06	26	1	
Palo Verde	1-174	From its intersection with Little Walnut Rd, east	Cottonwood Road	0.28	36	1	
Mum Street	1-175	From its intersection with Agua Blanca, west	North Hurley Rd ("one way")	0.09	10	1	
Niki's Road	1-176	From its intersection with North Swan, north	Cul de Sac @ .82 mi	0.82	20	1	
Kilamanjaro Court	1-177	From its intersection with Niki's Rd, west	Cul de Sac @ .14 mi	0.14	21	1	
Joseph Blane Road	1-178	From its intersection with Owens Road, north	Entrance to Monastery	1.34	14	3	
Pike Street	1-179	From its intersection with Peterson Drive, west	Cul de Sac @ .11 mi	0.11	20	1	
Olympus Street	1-180	From its intersection with Peterson Drive, east	.13 miles	0.13	12	1	
Lynx Lane	1-181	From its intersection with Little Walnut, west	Cul de Sac @ .27 mi	0.27	22	1	
Fawn Trail	1-182	From its intersection with Lynx Lane, west	Fawn Court	0.19	22	3	
Fawn Court	1-183	From its intersection with Fawn Trail, south	Cul de Sac @ .13 mi	0.13	22	3	
Railroad Drive	1-184	From its intersection with Broken Arrow, east	At .25 mi. Rd cont, not maint	0.25	18	3	
Wilmot Rd	1-185	From its intersection with N Swan, west	Foti's Road	0.05	22	1	
Foti's Rd	1-186	From its intersection with Wilmot N & S	At cul de sac north & south	0.10	22	1	
Everest Point Road	1-187	From its intersection with N Swan, west	Cul de Sac @ 0.07 mi	0.07	22	1	
Mt Olympus Road	1-188	From its intersection with Broken Arrow, east	Cul de Sac @ 0.35 mi	0.35	22	1	
Himalaya Way	1-189	From its intersection with North Swan, West	Cul de Sac @ .05mi	0.05	24	1	
Vesuvius Way	1-190	From its intersection with North Swan, West	Cal de Sac @ .48 mi	0.48	24	1	
Aleco Way	1-191	From its intersection with Vesuvius, North	Cul de Sac @ .10 mi	0.10	24	1	
Chimborraza	1-192	From its intersection with North Swan, East	Cul de Sac @ .13 mi	0.13	24	1	
Country Road	1-193	From its intersection with Rosedale Rd, South	Hitching Post Ridge	1.63	24	2	
Hitching Post Ridge	1-194	From its intersection with Country Road, South	Cul de Sac @ .90 mi	0.90	24	2	
Silver Spur	1-195	From its intersection with Hitching Post Ridge	Cul de Sac @ .12 mi	0.12	24	2	
Antelope Run	1-196	From its intersection with Lynx Lane, West	Cul de Sac @ .20 mi	0.20	24	1	
Camino De Viento	1-197	From its intersection with 180 - West	End of road at Cul De Sac	4.60	28	3	
Vantana De Sierra	1-198	From its intersection with Camino De Viento	End of road at Cul De Sac	0.80	20	3	
Mesita Circle	1-199	From its intersection with Camino De Viento	End of road at Cul De Sac	0.20	20	3	
Darling Bell	1-200	From its intersection with Cleveland Mine Rd	End of road at Cul De Sac	1.20	22	3	
Queen Lilian	1-201	From its intersection with Darling Bell	End of road at Cul De Sac	0.58	22	3	
King Peter	1-202	From its intersection with Darling Bell	End of road at Cul De Sac	0.20	22	3	
Market Street	1-203	From its intersection with State Right of Way	City Limits	0.27	22	1	
Gulch Lane	1-204	From its intersection with Camino De Viento	Intersection with Wind Canyon	0.90	24	3	
Babbling Brook Rd	1-205	From its intersection with Fleming Tank Rd	End of Cul De Sac	0.28	22	3	
Fleming Tank Rd	1-206	From its intersection with US-180	End of road	1.40	24	3	adjusted mileage
Wind Canyon Rd	1-207	From intersection with Fleming Tank	Gulch Lane	2.20	22	3	adjusted mileage
Quail Run	1-208	From intersection with Gulch Ln	End of road	0.66	22	3	5
Corto	1-209	From intersection with Loma Verde to N and S	End of road	0.31	20	3	

Acorn Dr	1-210	From intersection with Loma Verde to N and S	End of road	0.30	22	3	
Ventana Dr	1-211	From intersection with Loma Verde to N and S	End of road	0.25	20	3	
Loma Verde	1-212	From intersection with Kirkland Rd	Intersection with Ventana	0.85	22	3	
Old Ranch Rd	1-213	From intersection with McKinney Rd south	address 131	1.20	24	3	
Pack Saddle Rd	1-214	From intersection with Old Ranch Rd east	End of Cul De Sac	0.20	24	3	
Wind Mill Ridge	1-215	From intersection with Old Ranch Rd east	End of Cul De Sac	0.28	24	3	
Running Iron Ridge	1-216	From intersection with Old Ranch Rd east	End of Cul De Sac	0.36	24	3	
Airport Road	1-217	From intersection of US-180	Intersection of Ridge Rd	1.90	22	1	Rd Name Change
			Total Mileage District 1	163.96			

D-2							
Sacaton Road	2-1	From its intersection with Hwy 180, west	NM 293	25.38	25	3	
Little Dry Creek	2-2	From its intersection with Sacaton Road, NE	Catron County Line	2.00	18	3	
Moon Ranch Road	2-3	From its intersection with Sacaton Road, SW	Hwy 180 West	5.94	25	3	
Blue Rice Road	2-5	From its intersection with Sacaton Road, south	Sacaton Rd (loops back into)	0.35	14	3	
Nine-Sixteen Road	2-6	From its intersection with Sacaton Road, NE	Windmill @ Resident # 404	4.24	21	3	
Roland Ray Rice Road	2-7	From its intersection with Nine-Sixteen Rd, W	Last cattlegd-Resident #629	2.73	21	3	
Horse Lake Road	2-8	From its intersection with Hwy 180, west	Resident # 7618	1.80	23	3	
Stephens Road	2-9	From its intersection with Hwy 180, north	Resident # 318	0.40	23	3	Adjusted Mileage
Duck Creek Road	2-10	From its intersection with Stephens, south	Christian Center Road	3.54	24	3	
1st Duck Creek Crossing	2-11	From its intersection with Duck Creek, south	Hwy 180 West	0.30	15	3	
Clay Joe Lane	2-12	From its intersection with Duck Creek, SW	Hwy 180 West	0.20	21	3	
Christian Center Road	2-13	From its intersection with Hwy 180, east	Christian Center	0.65	24	3	
Shields Canyon Road	2-14	From its intersection with Hwy 180, east	Resident # 46	0.46	21	3	
Arena Road	2-15	From its intersection with Hwy 180, north	NM 211	1.60	20	1&3	
Mesa Road	2-16	From its intersection with Arena Road, east	NM 211	1.00	22	1	
Goble Drive	2-17	From its intersection with NM 211, south	Resident # 26	0.26	19	3	
Hickle Road	2-18	From its intersection with Goble Drive, south	1st culvt before #3(fence line)	0.30	19	3	
Box Canyon Road	2-19	From its intersection with EOP of NM293, north	Resident # 745 across creek	2.10	22	3	
Hooker Loop	2-20	From its intersection with NM 153, east	NM 153	8.03	19	3	
Donald Hooker Road	2-21	From its intersection with Hooker Loop, SE	Resident # 312 & # 314	0.82	19	3	
Agnew Road	2-22	From its intersection with Hooker Loop, south	Resident # 396	0.68	16	3	
David Hooker	2-23	From its intersection with Hooker Loop, north	Resident # 586	0.10	18	3	
Turkey Creek Road	2-24	From its intersection with NM 153 EOP, north	Gila River	10.26	20	3	
Shelley Road	2-25	From its intersection with Turkey Creek, north	Resident # 535	0.40	20	3	
Chacon Road	2-26	From its intersection with Turkey Creek, east	Resident # 19	0.19	16	3	
Clark Road	2-27	From its intersection with NM 211, east	Resident # 26	0.26	18	3	
L.C. Lance	2-28	From its intersection with NM 211, west	Resident # 17	0.17	18	3	
River Road	2-29	From its intersection with NM 211, west	Resident # 127	1.27	18	3	
Barka Road	2-30	From its intersection with NM 211, south	EOR (at .63 miles)	0.63	21	3	
Rice Road	2-31	From its intersection with Barka Rd, south	Resident # 18 turn around	0.20	17	3	
Gutierrez Road	2-32	From its intersection with NM 211, south	Resident # 10	0.10	12	3	
South Bear Creek Rd	2-33	From its intersection with NM 211, east	Resident # 115	1.15	22	3	
S Bear Creek Heights Rd	2-34	From its intersection with South Bear Creek, S	Resident # 16	0.16	18	3	
Cemetery Lane	2-35	From its intersection with NM 211, west	EOP	0.50	17	1	
Airport Mesa Road	2-36	From its intersection with NM 211, west	Hwy 180	1.75	21	1	
Leeville Road	2-37	From its intersection with Airport Mesa, west	Resident # 54	0.54	22	3	
Stailey Road	2-38	From its intersection with Leeville, Northeast	Cattleguard	0.25	20	3	
Reese Road	2-39	From its intersection with Airport Mesa, east	Hwy 180	0.30	17	3	
Bennett Road	2-40	From its intersection with Hwy 180, west	Gate entrance to resident	1.44	22	3	
Dinwiddie Road	2-41	From its intersection with Bennett Rd, south	Resident # 31	0.31	18	3	
Richard Dinwiddie Road	2-42	From its intersection with Dinwiddie Rd, south	Resident # 33	0.33	18	3	
Dickerson Road	2-43	From its intersection with Bennett Rd, south	Resident # 109	0.20	17	3	
Iron Bridge Road	2-44	From its intersection with Hwy 180 North	Hwy 180	0.45	21	1	
McCauley Road	2-45	From its intersection with Iron Bridge Road, west	Resident # 486	4.86	22	3	7

[illegible]

D-3							
Cerro Drive	3-1	From its intersection with NM 152, north	Resident # 12	0.10		3	
T. & M Road	3-2	From its intersection with Fierro Road, south	Resident # 22	0.19	20	3	
Chivas Road	3-3	From its intersection with NM 152, north	Resident # 8	0.08	23	3	
Becerra Road	3-4	From its intersection with Fierro Road, west	Resident # 5493 entrance	0.14	30	3	
Fierro Road	3-5	From its intersection with Fierro Road, north	Rocky hill before Shingle CY	6.00	30	1 & 3	
Cobo Road	3-6	From its intersection with Fierro Road, west	Resident # 67	0.06	12	3	
Zinc Hill Road	3-7	From its intersection with Fierro Road, west	Resident # 6	0.09	10	3	
Gutierrez Road	3-8	From its intersection with Fierro Road, west	Corner of resident # 75	0.05	10	3	
Lupe Rivera Road	3-9	From its intersection with Fierro Road, east	Resident # 94	0.08	17	3	
Young Road	3-10	From its intersection with Fierro Road, west	Resident # 99	0.13	28	3	
Roy Road	3-11	From its intersection with Fierro Road, west	Young Road	0.06	28	3	
Montoya Road	3-12	From its intersection with Fierro Road, west	Residents # 105 & # 107	0.09	12	3	
Luis Escobar Road	3-13	From its intersection with Fierro Road, west	Residents # 113	0.03	12	3	
Railroad "Y" Junction	3-14	From its intersection with Fierro Road, east	Hanover Creek	0.13	45	3	
Fierro School Bus T.A.	3-15	From its intersection with Fierro Road, west	Fierro Road (loops)	0.03	75	3	
Fierro Cemetery Road	3-16	From its intersection with Fierro Road, south	Hanover Creek	0.74	18	3	
San Antonio Church Road	3-17	From its intersection with Fierro Road, west	Church Parking Lots	0.40	24	3	
Iglesia Street	3-18	From its intersection with Fierro Road, east	Resident # 22	0.46	30	3	
Iglesia Loop	3-19	From its intersection with Iglesia, east	Resident # 4	0.26	20	1 & 3	
Hilario Chavez Road	3-20	From its intersection with Fierro Road, east	Iglesia Street resident # 16	0.16	45	3	
Luera Road	3-21	From its intersection with Hilario Chavez, east	Entrance to Resident # 44	0.30	20	3	
Majalca-Borunda Road	3-22	From its intersection with Luera Road, north	Resident # 33	0.30	20	3	
Hanover Creek Road	3-23	From its intersection with Fierro Road, north	Fierro Cemetery Road	1.23	43	3	
Emiterio Escobar Road	3-24	From its intersection with Hanover Creek, east	Resident # 10 gate	0.34	24	3	
Ray Castillo Road	3-25	From its intersection with Hanover Creek, north	Entrance to Resident # 56	0.10	10	3	
Luis Castillo Loop Road	3-26	From its intersection with Hanover Creek, north	Hanover Creek (loops into)	0.18	10	3	
Access Road to Fierro Rd	3-27	From its intersection with Fierro Road, east	Hanover Creek	0.02	37	3	
Hanover Cemetery	3-28	From its intersection with NM 152, south	Parking Lot -inside cemetery	0.14	20	3	
Georgetown Road	3-29	From its intersection with NM 152, north	SR 35	8.89	30	3	
Windmill Pasture Road	3-30	From its intersection with Georgetown, north	Gate to residents # 226	2.00	20	3	
Shingle Canyon Road	3-31	From its intersection with Georgetown, north	Gate to residents # 200	2.00	20	3	
Lamp Bright Road	3-32	From its intersection with NM 152, south	Entrance to Resident # 265	2.60	25	3	
Acklin Hill	3-33	From its intersection with NM 152, north	SR 35	1.13	16	1	
Ancheta Road	3-34	From its intersection with NM 152, south	Gate to resident # 45	0.45	14	3	
Galaz Street	3-35	From its intersection with NM 152, northwest	BOR of Ortiz Road	1.80	30	1 & 3	
Noonday Canyon Road	3-36	From its intersection with Galaz Street, north	Resident # 365	3.65	18	3	
F Street	3-37	From its intersection with Galaz Street, east	Entrance to resident # 11	0.08	16	3	
San Ysidro Street	3-38	From its intersection with F Street, south	Cemetery Gate	0.30	16	3	
San Francisco Street	3-39	From its intersection with Galaz Street, west	SR 35 (includes Y)	0.91	22	1	
San Lorenzo Street	3-40	From its intersection with Galaz Street, north	E Street	0.10	18	3	
Dominguez Street	3-41	From its intersection with San Lorenzo St, east	Entrance to resident # 6	0.03	10	3	
E Street	3-42	From its intersection with Galaz Street, east	Gate to resident # 11	0.10	18	3	
San Jose Street	3-43	From its intersection with E Street, north	Resident # 23	0.21	12	3	
Ponce Street	3-44	From its intersection with E Street, north	San Jose Street	0.07	10	3	9

D-3							
D Street	3-45	From its intersection with Galaz Street, east	Entrance to Resident # 15	0.15	21	3	
C Street	3-46	From its intersection with Galaz Street, north	Resident # 168 A	0.08	10	3	
Laguna Del Oso	3-47	From its intersection with SR 35, west	Callecita Del Oro	0.35	30	1	
Callecita De Oro	3-48	From its intersection with Laguna Del Oso, west	Rio Vista	0.34	30	1	
El Otro Lado Road	3-49	From its intersection with SR 35, north	Gate to Resident # 16	0.16	23	3	
Alice (Nacha) Salaiz Road	3-50	From its intersection with SR 35, south	Resident # 2879	0.30	16	3	
Allen Place	3-51	From its intersection with SR 35, north	Gate to resident # 2880	0.06	21	3	
Sage Drive	3-53	From its intersection with SR 35, north	SR 35	0.50	22	3	
Mimbres Yucca Drive	3-54	From its intersection with SR 35, south	Ocotillo Drive # 48 entrance	0.23	25	3	
Ocotillo Drive	3-55	From its intersection with Mimbres Yucca, west	Hummingbird Lane	0.94	22	3	
Mimbres Cactus Drive	3-56	From its intersection with Ocotillo, north	SR 35	0.34	27	3	
Chaparral Drive	3-57	From its intersection with Ocotillo, north	SR 35	0.44	30	3	
Grouse Lane	3-58	From its intersection with Ocotillo, north	Mimbres Quail Lane	0.13	22	3	
Hummingbird Lane	3-59	From its intersection with Ocotillo, west	SR 35	0.65	22	3	
Mimbres Dove Lane	3-60	From its intersection with Grouse, east	Chaparral Drive	0.35	22	3	
Mimbres Quail Lane	3-61	From its intersection with Grouse, east	Chaparral Drive	0.33	21	3	
Mockingbird Lane	3-62	From its intersection with Hummingbird, west	Resident #44	0.29	16	3	
Mariano Grijalva Road	3-63	From its intersection with SR 35, east	Resident # 3056	0.10		3	
Tony Grijalva Road	3-64	From its intersection with SR 35, east	Resident # 3112	0.11	12	3	
Hamilton Road	3-65	From its intersection with SR 35, east	Resident # 75	0.75	16	3	
Bear Canyon Road	3-66	From its intersection with SR 35, south	EOR at turn around	0.70	30	3	
Allie Canyon Road	3-67	From its intersection with SR 35, west	Corrals/Windmill	0.60	30	3	
Chestnut Street	3-68	From its intersection with SR 35, south	Embankment of creek	0.15	28	3	
Cottonwood Drive	3-69	From its intersection with Chestnut St, west	Mulberry Drive	0.08	22	3	
Mulberry Drive	3-70	From its intersection with Cottonwood,S @ # 3	Timber Drive	0.37	22	3	
Creek Road	3-71	From its intersection with Mulberry Drive, east	Gate Across creek (left)	0.18	18	3	
Orchard Drive	3-72	From its intersection with Mulberry, west	Mulberry Drive	0.20	12	3	
Box Elder Street	3-73	From its intersection with Mulberry, south	Timber Drive	0.07	15	3	
Timber Street	3-74	From its intersection with Mulberry, west	Forest Drive	0.08	12	3	
Forest Drive	3-75	From its intersection with Timber Drive @ # 4	Resident # 51 turn around	0.40	18	3	
San Juan Cemetery Road	3-76	From its intersection with Hwy 61, south	Cemetery Parking Area	0.25	14	3	
Royal John Mine Road	3-77	From its intersection with Hwy 61, north	Steel gate near brdg house	12.20	26	1 & 3	
De La O Road	3-78	From its intersection with Royal John Mine, W	Gate @ .95 miles	0.95	30	3	
Taylor-Graham Road	3-79	From its intersection with Royal John Mine, E	Resident # 30	0.45	14	3	
Silver Creek Road	3-80	From its intersection with Royal John Mine, W	Turn Around-Grandview Mine	5.43	22	3	
Hot Springs Road	3-81	From its intersection with Royal John Mine, E	Resident # 270, includes Y	2.80	24	3	
Taylor-Allison Road	3-82	From its intersection with Hot Springs Rd, north	Cattlegrd before resident #31	0.20	12	3	
Oliver Ranch Road	3-83	From its intersection with Hot Springs Rd, south	Resident # 28	0.28	14	3	
Oliver Rental Road	3-84	From its intersection with Oliver Ranch Rd, east	Resident # 26	0.10	12	3	
Valentine Dominguez Road	3-85	From its intersection with Hwy 61, east	Resident # 1504	0.20	14	3	
Dwyer Lane	3-86	From its intersection with Hwy 61, west	Resident # 27	0.27	12	3	
Faywood Cemetery Road	3-87	From its intersection with Hwy 61, north	Cemetery	0.30	12	3	
Taylor Mountain Road	3-88	From its intersection with Hwy 61, south	Gate @ 1.94 miles	1.94	60	3	
Ortiz Road	3-89	From its intersection with Galaz Street, north	Ortiz Ranch Gate	0.90	18	3	10

[illegible]

D-4							
Tyrone Mine Rd	4-1	From its intersection with Hwy 90, south	First gate @ .44 miles	0.45	21	1	
Tyrone-Thompson Road	4-2	From its intersection with Hwy 90, south	To 14.36 miles	15.08	18	3	
Tyrone-Thompson continues	4-2	From its intn with Hwy 90, south at Hidalgo Line	.8 Mi from Hidalgo Cty Line	0.80			
Silby Road	4-3	From its intersection with Tyrone-Thompson, S	Resident # 547	0.30	11	3	
Old Tyrone Townsite	4-4	From its intersection with Tyrone-Thompson, N	1st USFS c-guard(boundary)	1.40	14	3	
Burro Mtn Homestead Ro	4-5	From its intersection with Tyrone-Thompson, S	Resident # 665	0.60	11	3	
Forest Ridge Road	4-6	From its intersection with Tyrone-Thompson, N	Redrock Road	2.90	16	3	
Frank McCauley Road	4-7	From its intersection with Hwy 90, south	Resident # 2667	1.30	14	3	
Fargo Trail	4-8	From its intersection with Hwy 90, north	Creek	0.25	16	3	
Harry McCauley Road	4-9	From its intersection with Hwy 90, south	Resident # 2326 gate	0.91	12	3	
Chisolm Trail	4-10	From its intersection with Hwy 90, north	2nd Electrical Post past Y	0.25	19	3	
Outlaw Trail	4-11	From its intersection with Hwy 90, south	Cattleguard	0.15	11	3	
Gold Gulch Road	4-12	From its intersection with Hwy 90, north	Tyrone Thompson Road	6.70	10	3	
Jacks Peak Road	4-13	From its intersection with Gold Gulch, north	Windmill	1.00	18	3	
Walking X Ranch Road	4-14	From its intersection with Hwy 90, south	Resident # 50	0.50	14	3	
C-Bar Ranch Road	4-15	From its intersection with Hwy 90, south	Resident # 314	3.25	15	3	
Mill Canyon Road	4-16	From its intersection with Hwy 90, west	Resident # 747	7.88	13	3	
UT Drive	4-17	From its intersection with Hwy 180, south	Agave Street	0.34	24	3	
Coloradas Street	4-18	From its intersection with UT, east	Pony Express	0.17	24	3	
Agave Street	4-19	From its intersection with UT, east	Pony Express	0.18	24	3	
Pony Express	4-20	From its intersection with UT, east	Coloradas Street	0.14	24	3	
Saddle Rock Canyon	4-21	From its intersection with Hwy 180, west	1st cattleguard	1.40	18	3	
Mangus Valley Road	4-22	From its intersection with Hwy 180, south	Phelps Dodge Mine Road	11.70	30	1 & 3	
Haystack Canyon Road	4-23	From its intersection with Mangus Valley, south	Resident # 80	0.10	14	3	
Redrock Road	4-24	From its intersection with Mangus Valley, north	SR 464	23.90	30	1 & 3	
F Bar Ranch Road	4-25	From its intersection with Redrock Road, north	Resident # 1418	0.90	10	3	
Bird Nest Road	4-26	From its intersection with Redrock Road, north	Corrals @ 1.10 miles	1.10	10	3	
Road Canyon Road	4-27	From its intersection with Redrock Road, north	Corrals @ 1.20 miles	1.20	10	3	
Sherman Harper Road	4-28	From its intersection with SR 464, west	Corrals @ 1.77 miles	1.80	10	3	
Anderson Road	4-29	From its intersection with SR 464, west	Last Cattleguard	3.00	16	3	
Conner Road	4-30	From its intersection with SR 464's EOP	C-grd past Resident # 2416	2.90	24	3	
Harper Road	4-31	From its intersection with Conner Road, east	Resident # 2254	0.30	11	3	
Patton Road	4-32	From its intersection with Conner Road, north	Gate @ 4.14 miles	4.10	17	3	
Game Department Road	4-33	From its intersection with Patton Road, north	Gate before Resident # 514	4.70	16	3	
Robert Martin Road	4-34	From its intersection with Game Dept Road, N	Resident # 85	0.20	11	3	
Brown Ranch Road	4-35	From its intersection with Patton Road, north	Resident # 1161	11.70	14	3	
Martin Camp Road	4-36	From its intersection with Brown Ranch Rd, E	Resident # 528	1.00	14	3	
			Total Mileage District 4	114.55			
							12

[illegible]

D-6							
Tyrone-Ridge Access Road	6-1	From its intersection with Hwy 90, east	Ridge Road	8.80	20	3	
Cullum Drive	6-2	From its intersection with Hwy 90, east	Gate @ .69 miles	0.69	20	3	
Armijo Road	6-3	From its intersection with Cullum Drive, south	Coffey Circle (south side)	1.737	15	3	
Armijo Road continues		From its intersection with Cullum Drive, north	Hwy 90 (north side)				
Coffey Circle	6-4	From its intersection with Armijo Rd, east	Cul de Sac @ 0.25 mi	0.25	21	3	
Whitewater Road	6-5	From its intersection with Hwy 90, south	Ridge Road	19.94	20	3	
Frost Rd	6-6	From its intersection with Whitewater Rd, south	Corrals @ 9.98 miles	9.98	20	3	
Bertha Moore Road	6-7	From its intersection with Whitewater Rd, south	Resident # 1376	3.00	20	3	
Separ Road	6-8	From its intersection with Hwy 90, south	Last C-grd before I-10	32.70	22	3	
Jonnie McDonald Road	6-9	From its intersection with Separ, south	Separ Road	6.06	22	3	
Prevost Road	6-10	From its intersection with Separ, south	3rd arroyo crossing	2.30	22	3	
ACCESS Road to Gage	6-11	From its intersection with Separ, south	Gage Road	9.59	22	3	
		Includes Y intersecting with Gage Road					
Jones Ranch Road	6-12	From its intersection with Separ, north	Gate @ 2.60 miles	2.60	22	3	
Gage Road	6-13	From its intersection with Separ, north	Luna Cty Line Geo Mkr 1928	12.60	22	3	
Taylor Road	6-14	From its intersection with Separ, south	Separ Road	1.00	22	3	
Hughes Ranch Road	6-15	From its intersection with Interstate 10, south	Resident # 715	7.24	20	3	
Moore Ranch Road	6-16	From its intersection with Interstate 10, south	Resident # 360	3.65	20	3	
South Wells Road	6-17	From its intersection with Hwy 146, west	Hwy 9	6.62	20	3	
Little Hatchet Mountain Rd	6-18	From its intersection with Hwy 9, south	Gate - Hidalgo County Line	15.85	18	3	
1st Street	6-19	From its intersection with Hwy 9, south	Before Resident # 34	0.30	20	3	
2nd Street	6-20	From its intersection with Hwy 9, south	Avenue B	0.39	20	3	
3rd Street	6-21	From its intersection with Hwy 9, south	Avenue C	0.29	20	3	
4th Street	6-22	From its intersection with Hwy 9, south	Avenue C	0.21	20	3	
5th Street	6-23	From its intersection with Hwy 9, south	Avenue C	0.20	20	3	
Avenue A	6-24	From its intersection with Hwy 81, west	EOR @ .55 miles	0.55	20	3	
Avenue B	6-25	From its intersection with Hwy 81, west	1st Street	0.45	20	3	
Avenue C	6-26	From its intersection with 5th Street, west	3rd Street	0.19	20	3	
Shipping Pens Road	6-27	From its intersection with Hwy 9, south - 4.5 mi	Shipping Pens	2.80	18	3	
Mitchelle Lane	6-28	From its intersection with Cullum Drive, north	Cul de Sac @ .446 mi	0.446	16	3	
Otis Lane	6-29	From its intersection with Michelle Lane, east	Cul de Sac @ .180 mi	0.18	16	3	
Marguerite Lane	6-30	From its intersection with Armijo Road, east	Kristine Lane cul de sac	0.482	15	3	
Kristine Lane	6-31	From its intersection with Armijo Road, east	Marguerite Lane cul de sac	0.299	16	3	
[SEAL]							
			Total Mileage District 6	151.39			
<i>Marisa Castriello</i>							
Marisa Castriello,	County Clerk		Grand Total	697.93			
							14